

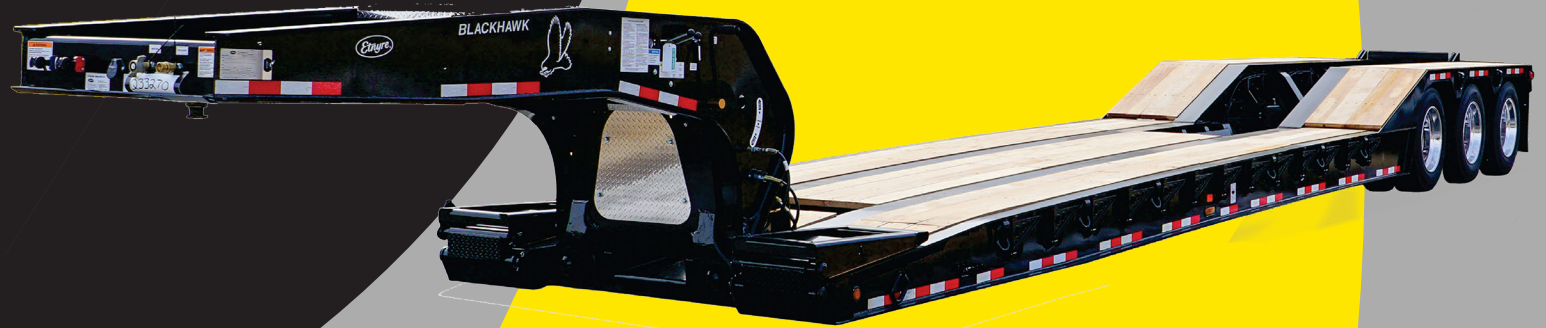

# LowBoy Trailers



Our selection of legendary Blackhawk LowBoy Trailers





# BLACKHAWK Classic Series

## Hydraulic Detachable Gooseneck

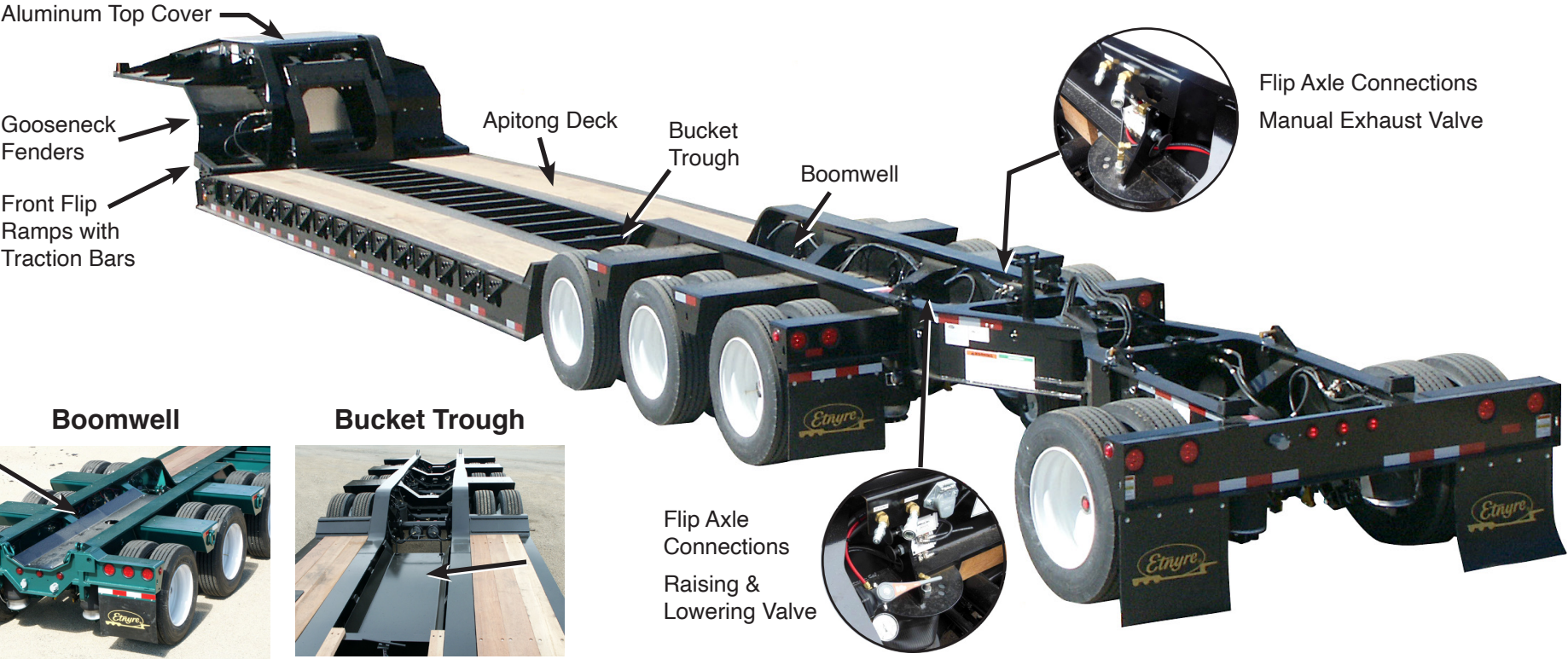
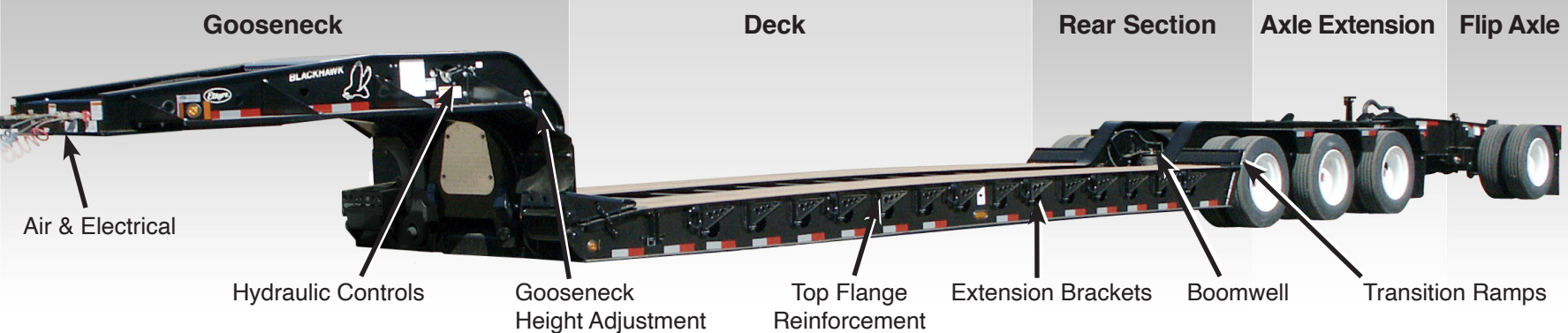

# Hydraulic Detachable Goosenecks

Hydraulic non-ground engaging, pin and stirrup design with high-lift and adjustable fifth wheel heights of 48", 50", 52", 54" & 56" based on 50" loaded fifth wheel height. Multiple swing clearances available.

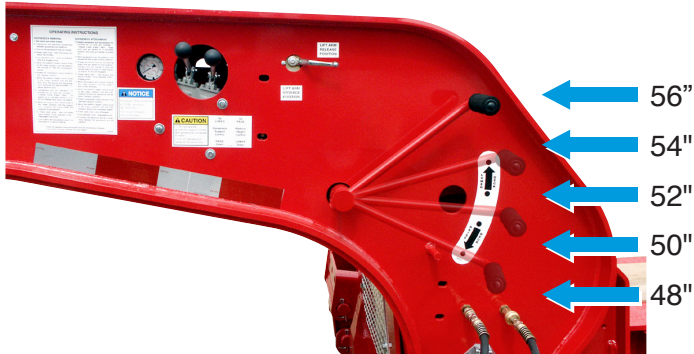
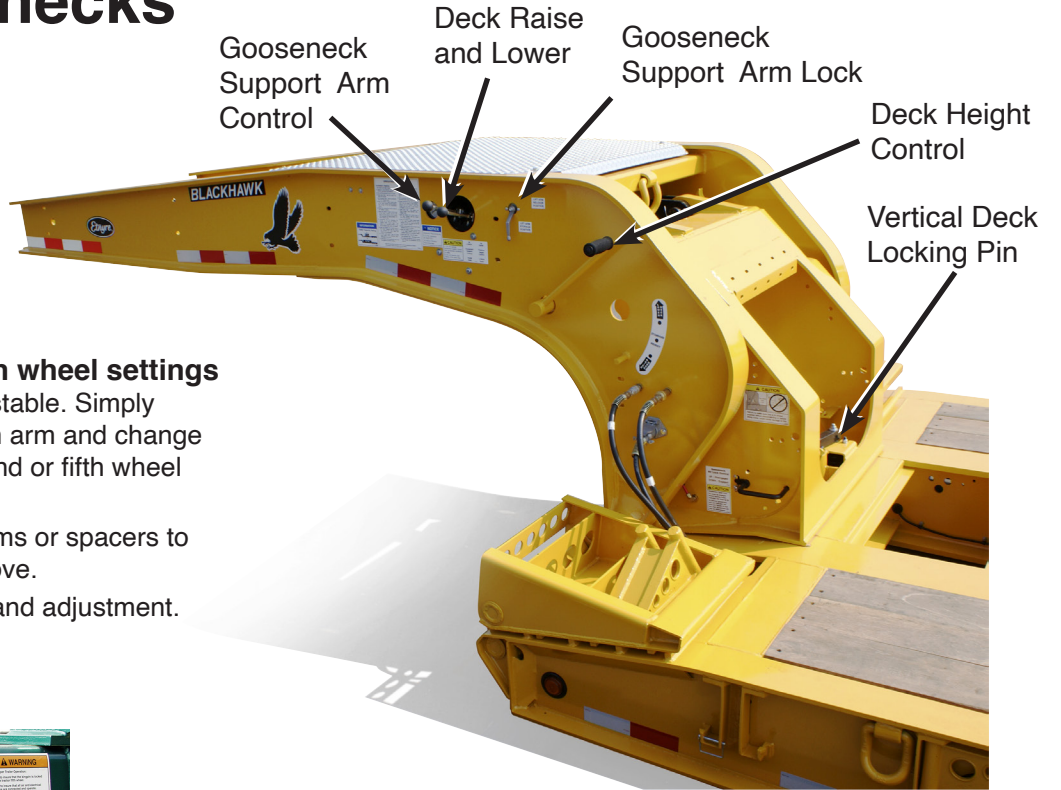

**Multiple fifth wheel settings** are cam adjustable. Simply move the cam arm and change deck height and or fifth wheel settings. No doors, shims or spacers to install or remove. Simple one hand adjustment.

Simple quick and easy hook-ups to any tractor air, electrical and hydraulic system.



**Simple and quick to operate with only two levers.**

Includes a hydraulic pressure gauge to monitor hydraulic pressure from tractor wet line or (optional) power pack.

In about 30 seconds the driver can be pulling away from the trailer deck and just as quickly back in and hook up ready to go.

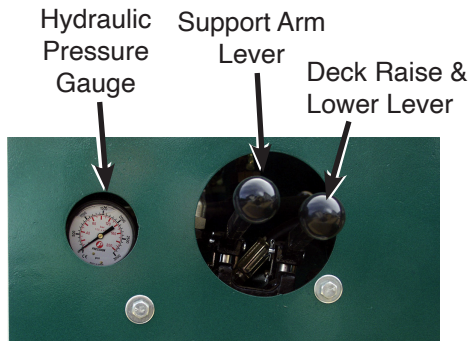

## Vertical Deck Locking Pin

Designed for ease of operation our deck locking system is quick and easy to use as well as virtually maintenance free.

High visibility gives the operator the comfort of knowing the deck is secured to the gooseneck.

Backing into the trailer is a breeze with the pin left down while backing. The positive lock is felt before leaving the cab.



# Goosenecks - Features and Options

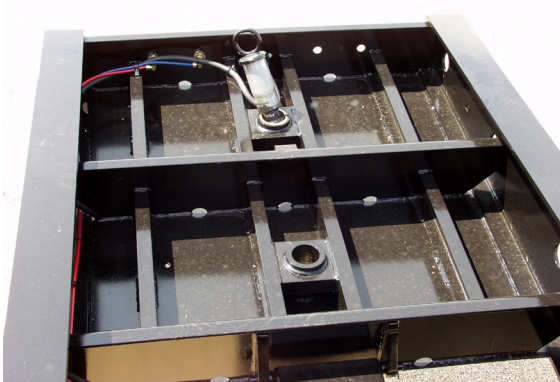

## Dual King Pin Settings

Etnyre uses the floating removable type of king pin when multiple settings are required. This makes for a quick and clean change from one setting to another.

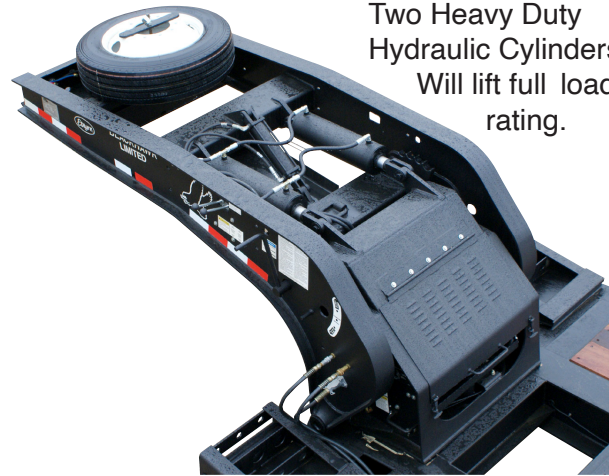

Two Heavy Duty Hydraulic Cylinders Will lift full load rating.

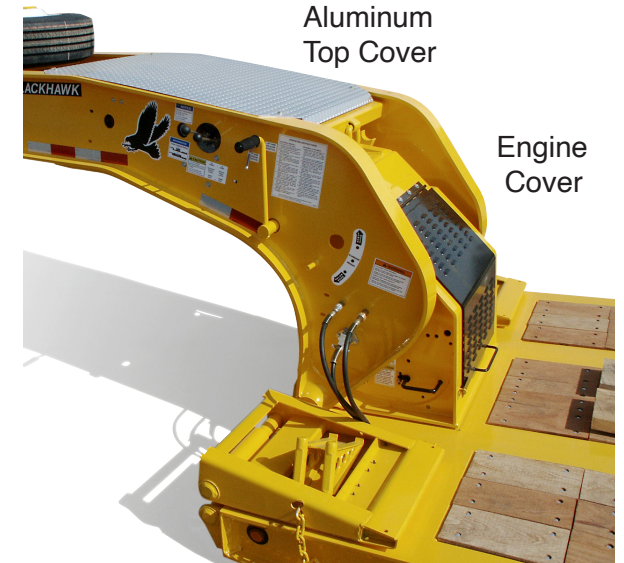

Aluminum Top Cover

Engine Cover



Gooseneck Support Arm



Optional Gooseneck Fenders



Flip over extension.



Optional Power Pack 13 HP Honda

# Goosenecks - Features and Options

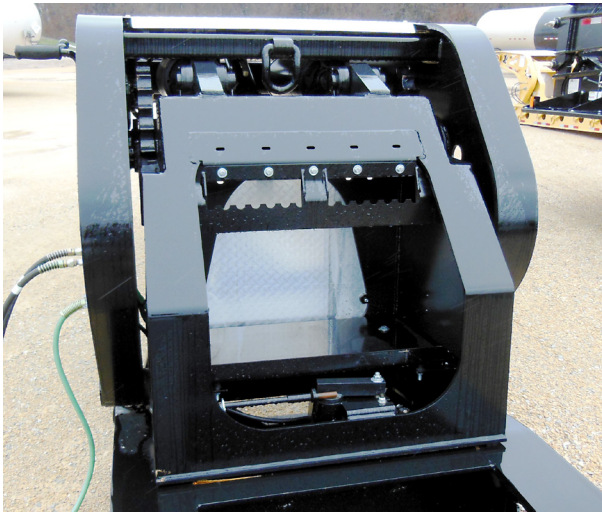

Chain and Binder Rack with Base



Pull out - swing out wide load lights.

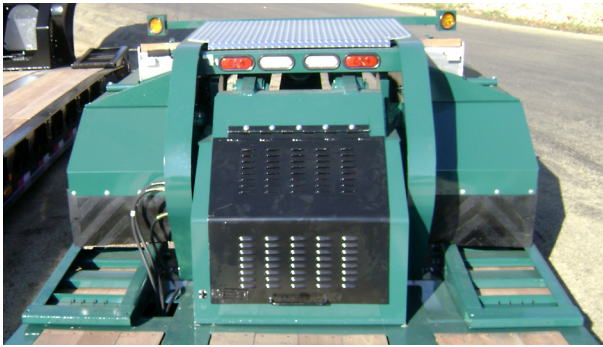

Full Lockable Door

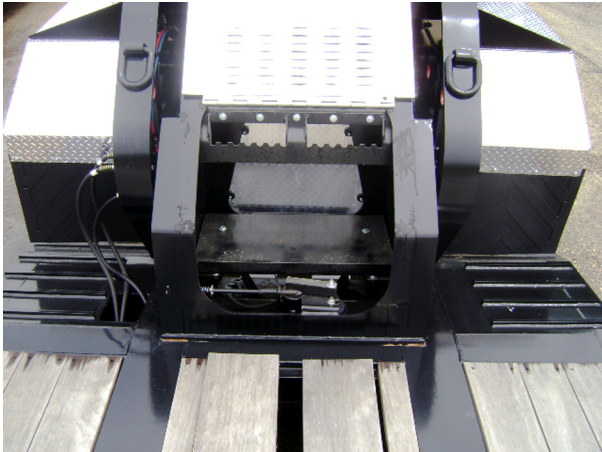

Chain and Binder Rack with Base and aluminum cover.



Full Lockable Door with Light Bar and Aluminum Gooseneck Fenders

# Goosenecks - Features and Options

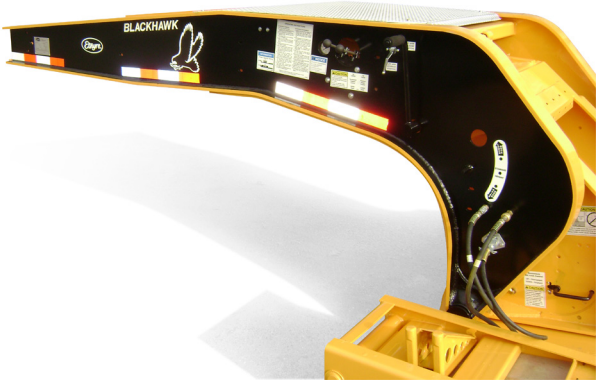

Standard Gooseneck



Low Profile Gooseneck



Flip Under Hat Box



Tandem Jeep Gooseneck



Tandem Jeep Gooseneck



Tandem Jeep Gooseneck



Tri Axle Jeep Gooseneck



Short Tri Axle Jeep Gooseneck

# Goosenecks - Other Models

## Mechanical Removable



Mechanical Detachable Gooseneck



Full Width Mechanical Goosneck



Narrow Mechanical Gooseneck with Fenders



Mechanical Gooseneck with Hydraulic Power Tower

## Folding



Hydraulic Folding Gooseneck - Tapered Nose



Hydraulic Folding Gooseneck - Tapered Nose



Hydraulic Folding Gooseneck - Knife Nose



# Decks

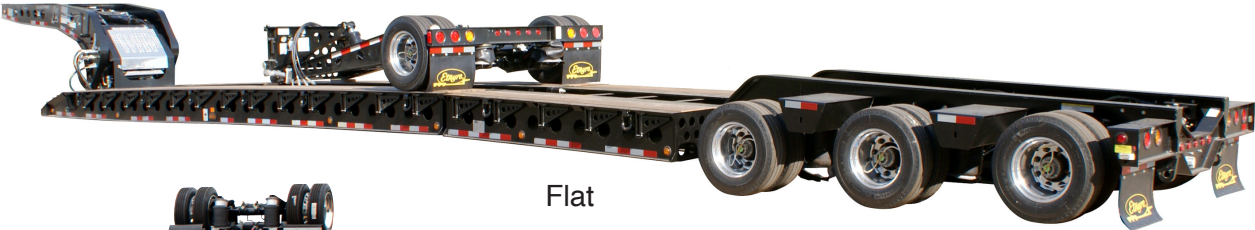

Flat



Drop Side



Flat Floor



Flat Floor



Beam Deck



Paver Style



Flat Floor



Well Deck



Drop Side

## Decks - Front Ramps



None



16" Fixed



Paver Style



31" Fold Over

## Decks - Features and Options



Boom trough and bucket well are **standard** features on the Blackhawk series hydraulic detachable trailers. Boomwell cover plate is optional equipment.



Extension bracket and bent lash ring.

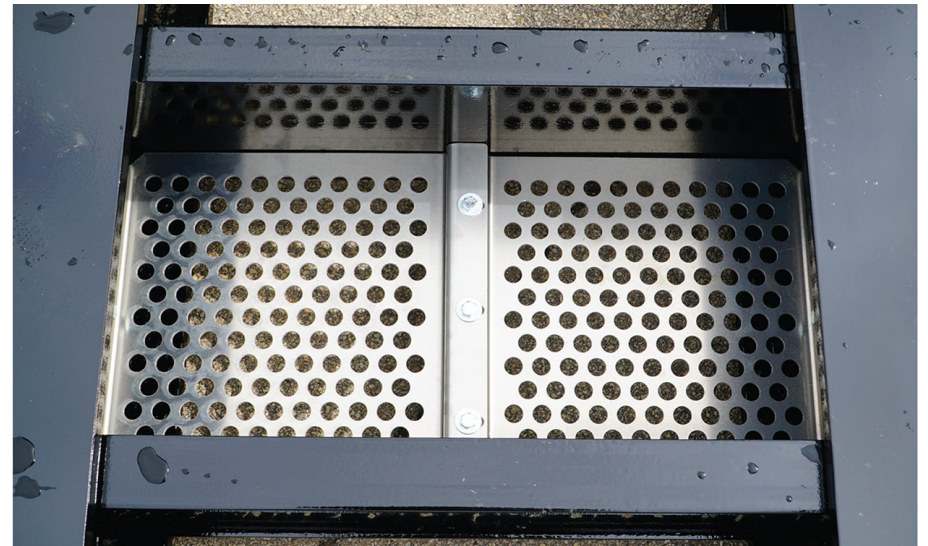

Storage basket to hold a variety of objects. One storage basket is standard with options for others.

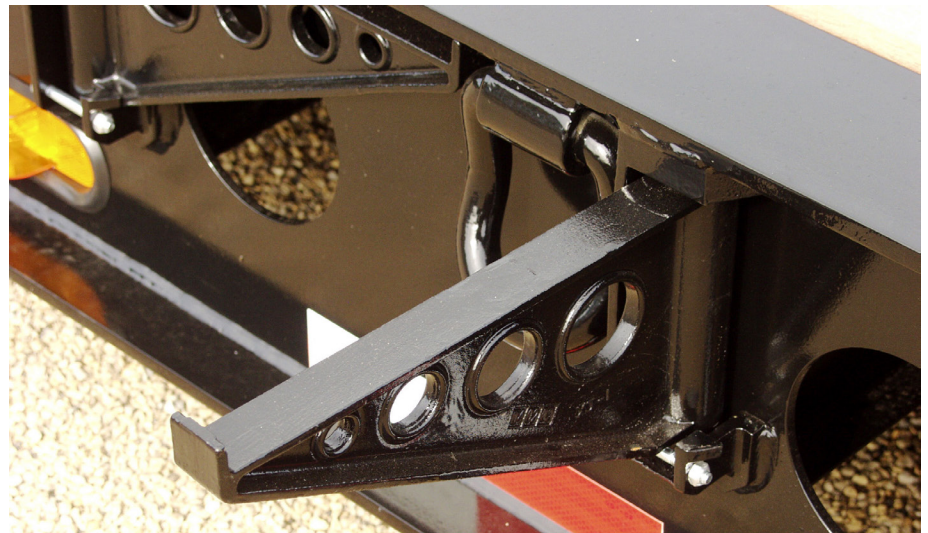

Standard outriggers are locked out by a tab on the bracket. They are also locked in the transport position. One bolt replaces damaged or missing outriggers.

## Decks - Features and Options



Beam Deck with lash rings.



Outrigger planks with spring tie downs.



Drop Side with wheel pockets.

## Rear Section - Optional rear wheel covers



Open rear.



Individual (bolt on) 2 axle.



One piece (bolt on).



Individual (bolt on) 3 axle.



One piece (weld on) with traction bars.



One piece (bolt on).



Integral (weld on).

# Flip Fourth Axle

With Air Actuated Locking Option

Also Available with 3rd Axle Air Lift



## Hydraulic Flip Fourth Axle



# Stingers



Hydraulic Folding Stingers



# Beavertails

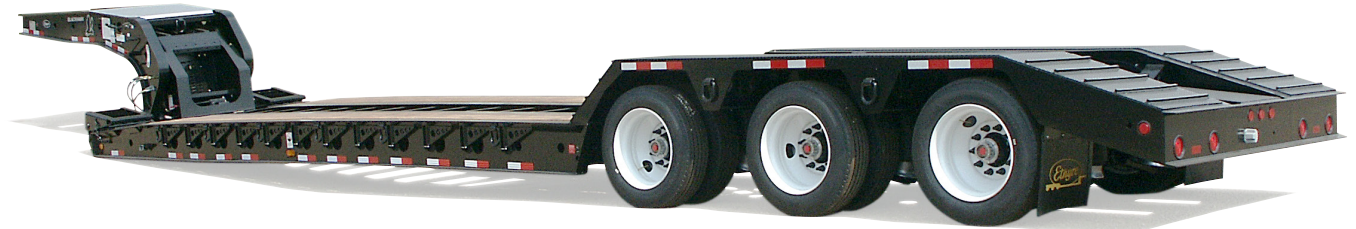



# Paver Special - RTN Series

## Hydraulic Removable Gooseneck



55 ton



35 ton

- 35 and 50 ton models.
- Full width rear deck.
- Hydraulic high lift non ground engaging gooseneck.  
35" vertical gooseneck travel.
- Adjustable 5th wheel height.
- Optional open rear deck.
- Optional rear boomwell filler.



# Rear-Loading Paver Special - RPS Series



- Fast and easy hydraulically operated ramps.
- Low 8° rear ramp climb angle.
- One man operation.
- Full width goesneck with 3 to 1 slope accomodates most rollers.



# SR Series

## Hydraulic Ramp Trailer

- 35 and 50 ton capacity.
- Full width gooseneck.
- Outside hydraulic controls.
- Load carrying hydraulic rear ramp.
- Load from the ground or dock.



# MRG

## Mechanical Removable Gooseneck



- Light weight - low deck height.
- 25 to 55 ton models.
- Custom deck lengths.
- Custom widths 8' to 10'.
- Custom 5th wheel height.
- Custom crossmember spacing.

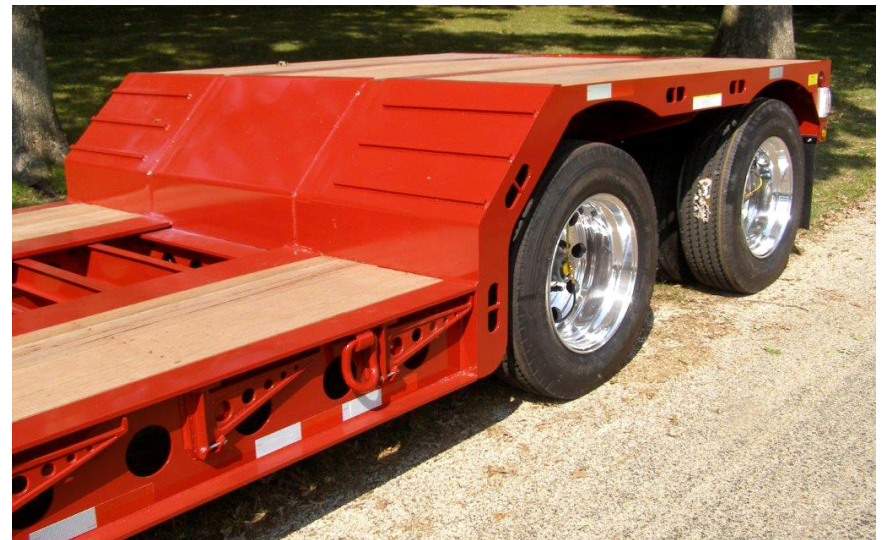

# Extendable

MRG Extendable



RTN Extendable



- 35 to 60 ton capacity.
- Mechanical (MRG) and Hydraulic detachables (RTN).
- Full width and narrow neck.
- Multiple configurations (2 axle - 2+3+2).

- Greaseable deck rollers.
- Multiple tire and brake configurations.



# Custom Trailers

Available in multiple configurations:

Drop Side

Beavertail

Spread Axle

Stinger

2 + 2

3 + 2

3 + 3

Jeeps

East Coast

West Coast

Removable Rear Sections

Beam Configurations

Extendables



# Spread Axle Configurations



3 + 3 + 3



2 + 2 + 2



4 Axle  
Close Coupled



3 + 1



2 + 3 + 2



75 ton Capacity  
Drop Deck  
Jeep and Dolly







Hydraulic Removable Gooseneck  
80 Ton Capacity





Hydraulic Removable Gooseneck  
40 Ton Capacity  
with pullout deck extensions













Dealer/Customer Approval \_\_\_\_\_ Date \_\_\_\_\_

### Standard BLACKHAWK TRAILERS

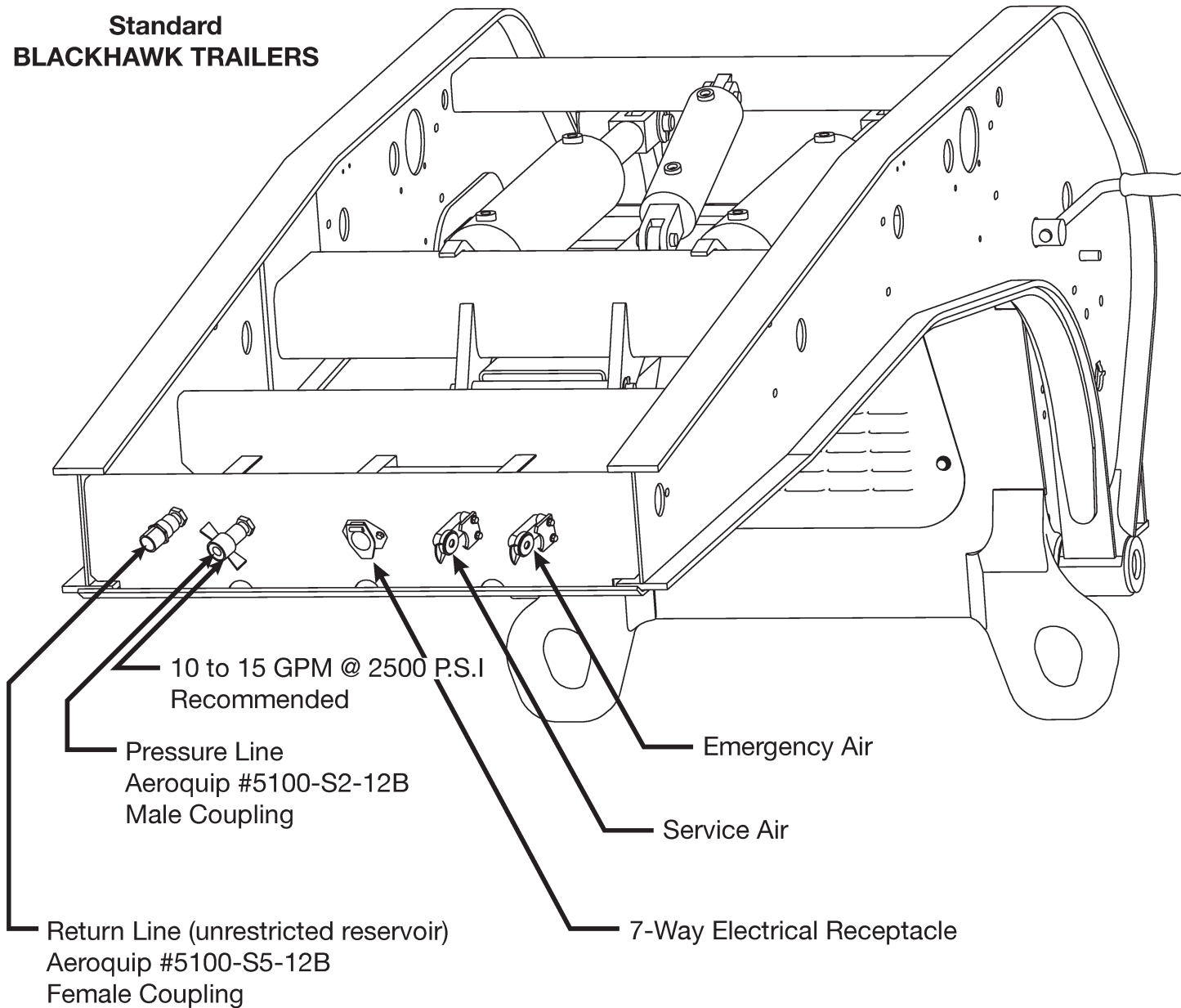

#### Pressure Requirements

1. Minimum: 7 to 10 Gallons per minute
2. 35 ton: 2,500 P.S.I
3. 55 ton: 2,500 P.S.I
4. 60 ton: 2,500 P.S.I

#### Tank Requirements

1. Minimum tank size: 10 Gallons
2. Recommended tank size:  
20 gallons

#### Filter Requirements

1. Hydraulic Return Line Spin-On Filter
2. 10 Microns filter rating
3. Minimum 20 G.P.M flow rating with  
15 P.S.I by-pass spring

Drawing is for illustrative purposes only. All weights and dimensions are approximate. Trailer is shown in fully loaded condition. Platform heights will increase if loaded less than full capacity.

E.D. ETNYRE & CO.  
Oregon, IL. 61061

All dimensions in inches. Do not scale drawing

HYDRAULIC, ELECTRIC  
AND AIR CONNECTIONS

DRAWING NO. **RTN-2763**

DATE: 10/26/23



Dealer/Customer Approval \_\_\_\_\_ Date \_\_\_\_\_

## BLACKHAWK LIMITED Trailer Requirements

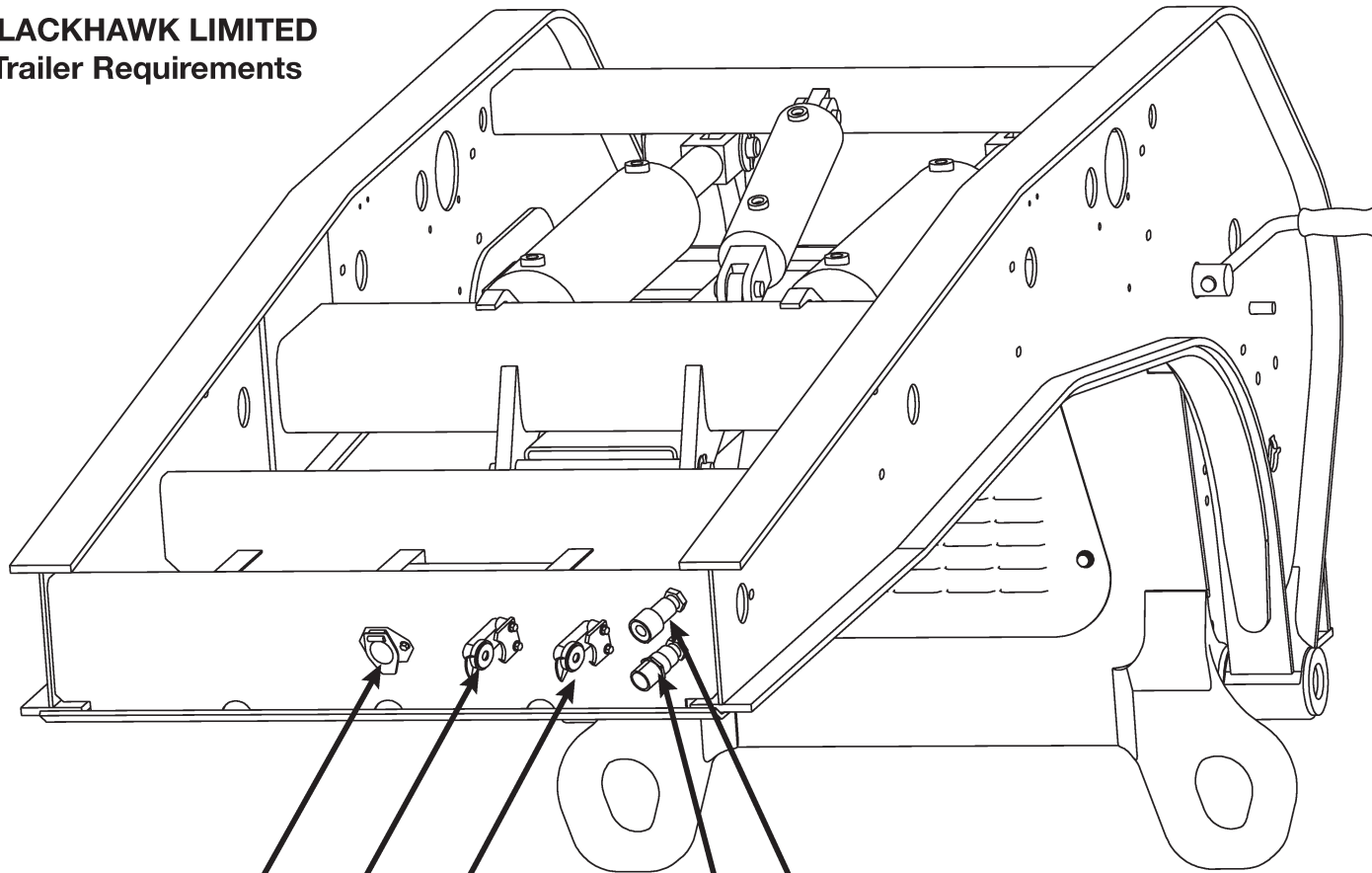

7-Way Electrical  
Receptacle

Service Air

Emergency Air

Pressure Line  
(Pioneer 4650-4 Female Coupling)

Return Line  
(Pioneer 4610-4 Male Coupling)

### Pressure Requirements

1. Minimum: 7 to 10 Gallons per minute
2. 35 ton: 2,500 P.S.I
3. 50/55 ton: 2,500 P.S.I

### Tank Requirements

1. Minimum tank size: 10 Gallons
2. Recommended tank size:  
20 gallons

### Filter Requirements

1. Hydraulic Return Line Spin-On Filter
2. 10 Microns filter rating
3. Minimum 20 G.P.M flow rating with  
15 P.S.I by-pass spring

E.D. ETNYRE & CO.  
Oregon, IL. 61061

All dimensions in inches. Do not scale drawing

HYDRAULIC, ELECTRIC  
AND AIR CONNECTIONS

DRAWING NO. **RTN-3300**

DATE: 10/26/23

Drawing is for illustrative purposes only. All weights and dimensions are approximate. Trailer is shown in fully loaded condition. Platform heights will increase if loaded less than full capacity.

# Recommended Practice

## Outrigger Loadings:

Outriggers (also called extension brackets) are frequently used to extend the useful width of the deck by approximately 12" on each side (approximately 24" total). The proper loading procedure is very important.

## Recommended Practice

The centerline of the vehicle tracks or tires must be no wider than the outside edge of the deck.

## Outrigger Planks

Standard outriggers are designed for use only with 2" thick outrigger planks.



Outriggers are designed for use only with 2" thick outrigger planks; therefore, the use of thicker boards and/or loading practices that disregard these recommended practices may result in outrigger failures (breakage) and resultant equipment damage and personal injury.

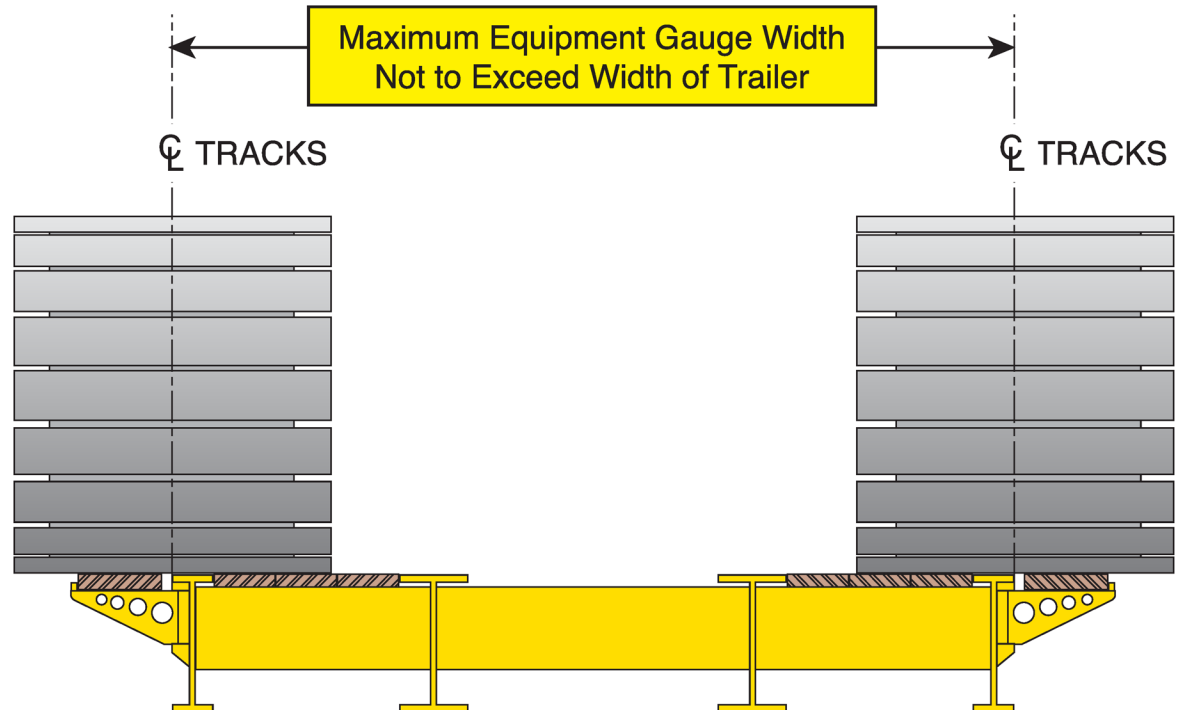

# Recommended Practice

## Gooseneck Support Arm

The gooseneck support arm (also called support cylinder) is a hydraulic cylinder attached to a movable arm that “supports the hydraulic removable gooseneck on the truck/tractor framework while the gooseneck is being removed from the trailer deck during the loading or unloading procedures.

## Support Arm Position

The support arm is located so that it comes in contact with most standard truck/tractor frames. However, because truck/tractor frames do vary from manufacturer to manufacturer *it may be necessary to alter the frame or to add a landing pad for the support arm to rest upon.*

## CAUTION

The gooseneck support arm should be used only to support the gooseneck. Pushing or lifting the truck frame or the front of the deck may result in damage to the truck/tractor framework, the support arm or the support cylinder.

When reattaching the gooseneck to the deck the support arm must be retracted (lifted up) prior to moving the trailer. Failure to retract the support arm could result in damage to the support arm, the support cylinder, the truck frame or the truck fenders.

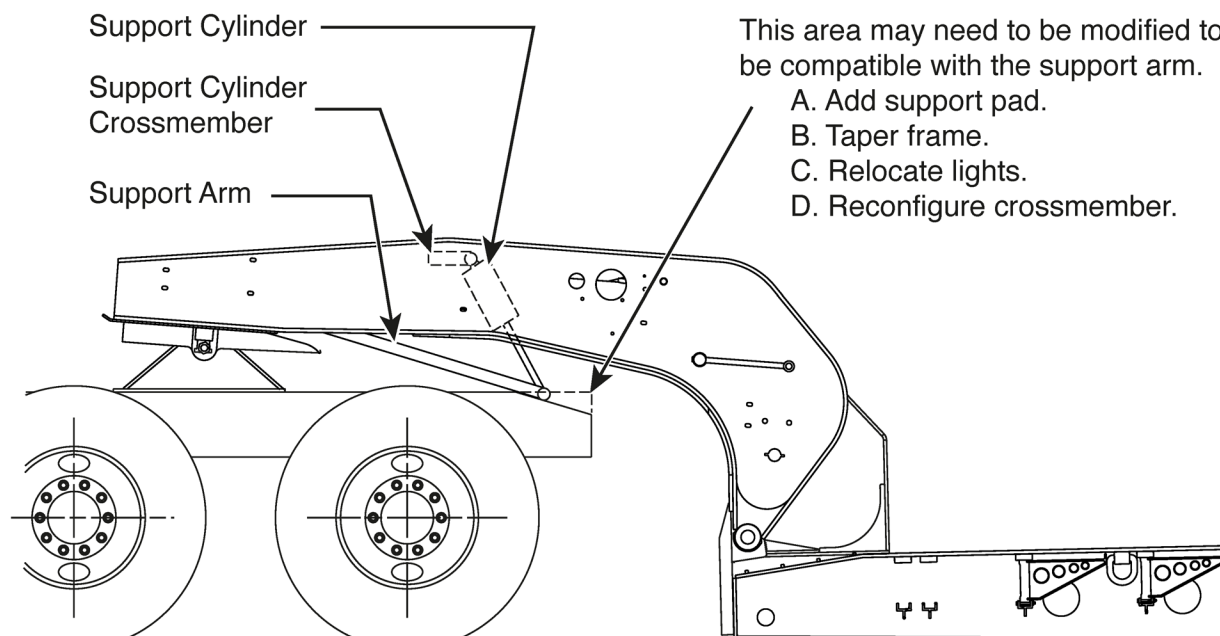



# BLACKHAWK



**Classic Series Trailers**  
(Hydraulic Detachable Gooseneck)



1333 South Daysville Road, Oregon, Illinois 61061  
Phone: 800-995-2116 or 815-732-2116 • Fax 815-732-7400  
Web Site: [www.etnyre.com](http://www.etnyre.com) • E Mail: [sales@etnyre.com](mailto:sales@etnyre.com)

**A-508-23**  
Updated March 11, 2024

© Copyright 2015 E. D. ETNYRE & CO. All rights reserved. No part of this publication may be reproduced by any means, electronic or mechanical, without the express permission of E. D. ETNYRE & CO.

